

# PLAT OF SURVEY

LOT 1, CHRISTON HEIGHTS, A SUBDIVISION, TOWN OF WHITEWATER, WALWORTH COUNTY, WISCONSIN.

STATE OF WISCONSIN  
COUNTY OF ROCK SS.

I HEREBY CERTIFY THAT I HAVE SUPERVISED THE SURVEY OF THE PROPERTY DESCRIBED HEREON FOR THE EXCLUSIVE USE OF DILLON INVESTMENTS, LLC AND THAT TO THE BEST OF MY KNOWLEDGE AND BELIEF THE PLAT HEREON DRAWN CORRECTLY REPRESENTS SAID SURVEY AND ITS LOCATION AND COMPLIES WITH CHAPTER A-E7.

GIVEN UNDER MY HAND AND SEAL THIS 19th DAY OF JANUARY, 2023,  
AT JANESVILLE, WISCONSIN.

*R M Combs*  
RYAN M. COMBS, PLS NO.2677

If the surveyor's signature is not red in color, the map is a copy and may contain unauthorized alterations. The certification contained hereon shall not apply to any copies.

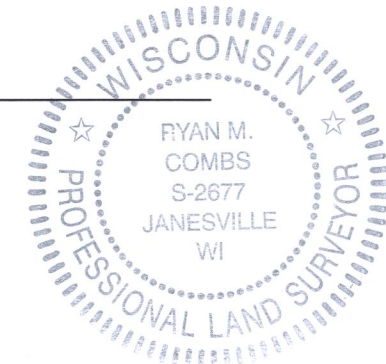

## LEGEND:

- FOUND 3/4" IRON PIN
- ⊙ FOUND IRON PIPE - 1" DIA. UNLESS OTHERWISE SHOWN
- x-x- FENCE

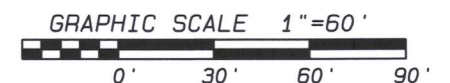

## NOTES:

FIELDWORK COMPLETED JANUARY 18, 2022.

THIS SURVEY IS SUBJECT TO ANY AND ALL EASEMENTS AND AGREEMENTS, RECORDED AND UNRECORDED.

ASSUMED N15°55'38"E ALONG THE WEST LINE OF SAID LOT 1.

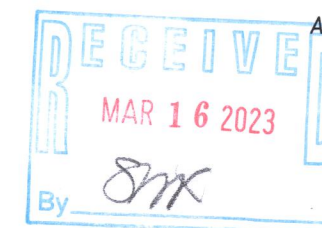

LOT 2 - CHRISTON HEIGHTS, A SUBDIVISION

Project No. 122-550 DILLON

**Combs & Associates**

- LAND SURVEYING
- LAND PLANNING
- CIVIL ENGINEERING

109 W. Milwaukee St.  
Janesville, WI 53548  
www.combsurvey.com

tel: 608 752-0575  
fax: 608 752-0534

DOHR-1

415-1601